



SES COLLEGE SREEKANDAPURAM

(Accredited by NAAC with 'B' Grade) Affiliated to Kannur University



Criterion 4

Infrastructure and Learning Resources

4.1 Physical Facilities

4.1.3 Percentage of classrooms and seminar halls with ICT- enabled facilities such as smart class, LMS, etc.



SES COLLEGE

SREEKANDAPURAM
EDUCATIONAL
SOCIETY

Affiliated to **Kannur University**
Accredited by **NAAC at 'B' Grade**

SREEKANDAPURAM POST,
KANNUR DISTRICT,
KERALA, PIN:670631
PH: 0460 2230293, 2231145



S.E.S. COLLEGE

www.sescollege.ac.in • sescollege.skprm@gmail.com • principal.sescollege@gmail.com

Details of class rooms and Seminar Hall

Total number of class rooms and Seminar hall : 46

CLASSROOM SPECIFICATIONS (AIDED)

A Block

Sl No.	Room Number	Room Name	Area (Meter Square)	Purpose
1	A2	I DC English	96.05	Class room for teaching and learning
2	A13	I DC Chemistry	52.85	Class room for teaching and learning
3	A14	II DC B.Com	52.85	Class room for teaching and learning
4	A15	I DC BBA	52.85	Class room for teaching and learning
5	A16	II DC BBA	52.85	Class room for teaching and learning
6	A18	II DC BA Economics	52.13	ICT enabled class room to improve learning
7	A19	I DC BA Economics	50.94	Class room for teaching and learning
8	A20	III DC BA Economics	50.77	ICT enabled class room to improve learning
9	A22	II DC BA English	32.6	ICT enabled class room to improve learning
10	A23	III DC BA English	52.85	ICT enabled class room to improve learning

11	A24	Smart Room	156.31	ICT enabled room with recording facilities
12	A25	I PG M A Journalism	51.78	Class room for teaching and learning
13	A26	II PG M A Journalism	53.05	ICT enabled class room to improve learning
14	A27	III DC B.Com	52.85	ICT enabled class room to improve learning

B Block

Sl No.	Room Number	Room Name	Area (Meter Square)	Purpose
15	B3	III DC BBA	75.89	ICT enabled class room to improve learning
16	B4	III DC B.Sc Mathematics	39.35	ICT enabled class room to improve learning
17	B5	II DC B.Sc Physics	39.35	ICT enabled class room to improve learning
18	B7	I DC B.Com	75.89	Classroom for teaching and learning
19	B11	III DC B.Sc Chemistry	50.64	ICT enabled class room to improve learning
20	B14	Seminar Hall		Seminar hall used for various purposes like guest lectures,workshops,exhibitions etc.
21	B18	I DC B.SC Mathematics	79.55	Class room for teaching and learning
22	B19	II DC B.Sc Mathematics	77.4	Class room for teaching and learning
23	B21	III DC B.Sc Physics	54.68	Class room for teaching and learning
24	B22	II DC B.Sc Chemistry	55.5	Class room for teaching and learning
25	B23	I DC B.Sc Physics	79.65	Class room for teaching and learning

CLASSROOM SPECIFICATIONS (UNAIDED)

Sl.No	Room No	Name of the Department	Area	Purpose
26	3	B.Com Comp.Application I	63 M2	Class room for teaching and learning
27	4	B.Com Comp.Application II	63 M2	Class room for teaching and learning
28	5	B.Com Comp.Application III	63 m2	Class room for teaching and learning
29	6	Audio Visual Room	63m2	Classroom for teaching and learning
30	7	M.Com Finance I	63 M2	ICT enabled class room to improve learning
31	8	M.Com Finance II	61.2 M2	ICT enabled class room to improve learning
32	9	B.C.A III	62.1 M2	Class room for teaching and learning
33	10	B.C.A II	63 M2	Class room for teaching and learning
34	12	M.Sc C.S II	31.5 M2	Class room for teaching and learning
35	13	M.Sc C.S I	31.5 M2	Class room for teaching and learning
36	14	B.Sc C.S I	30.15 M2	Class room for teaching and learning
37	15	B.Sc C.S II	32.4 M2	Class room for teaching and learning
38	16	B.C.A I	63 m2	Class room for teaching and learning
39	19	M.Com I B I	31.5m2	Class room for teaching and learning
40	20	M.Com I B II	30.6m2	Class room for teaching and learning
41	24	B.Sc C.S III	50.5m2	Class room for teaching and learning
42	25	M.A English II	50.5m2	Class room for teaching and learning
43	26	M.A English I	48.2m2	Class room for teaching and learning
44	27	B.A English III	48.2m2	Class room for teaching and learning
45	28	B.A English II	49.1m2	Class room for teaching and learning
46	29	B.A English I	49.1 m2	Class room for teaching and learning



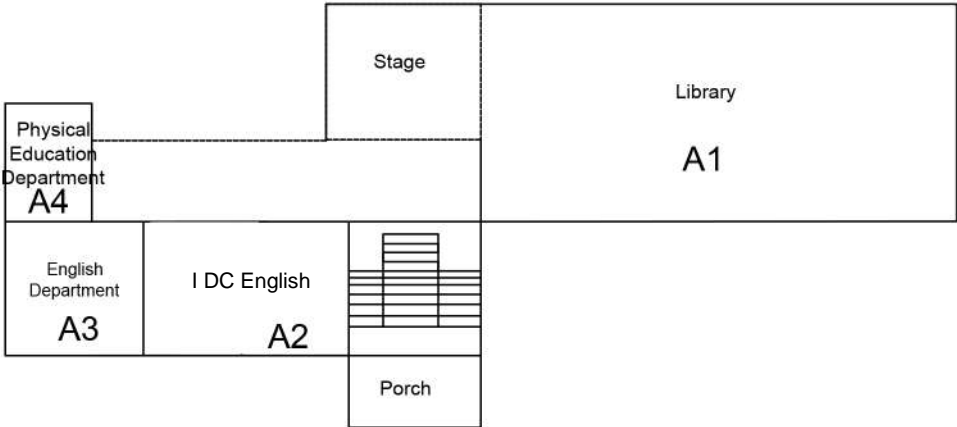
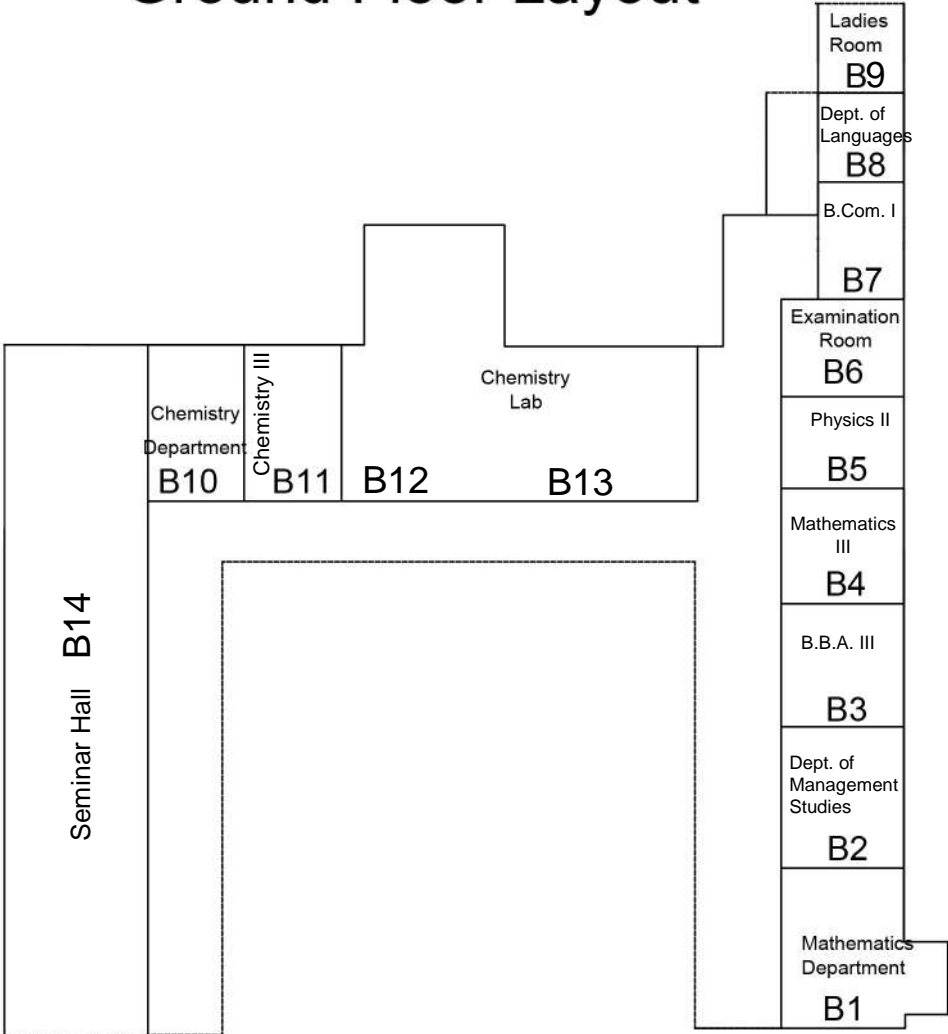

 Dr. DOMINIC THOMAS
 Principal
 S.E.S. COLLEGE
 SREEKANDAPURAM

Ground Floor Layout

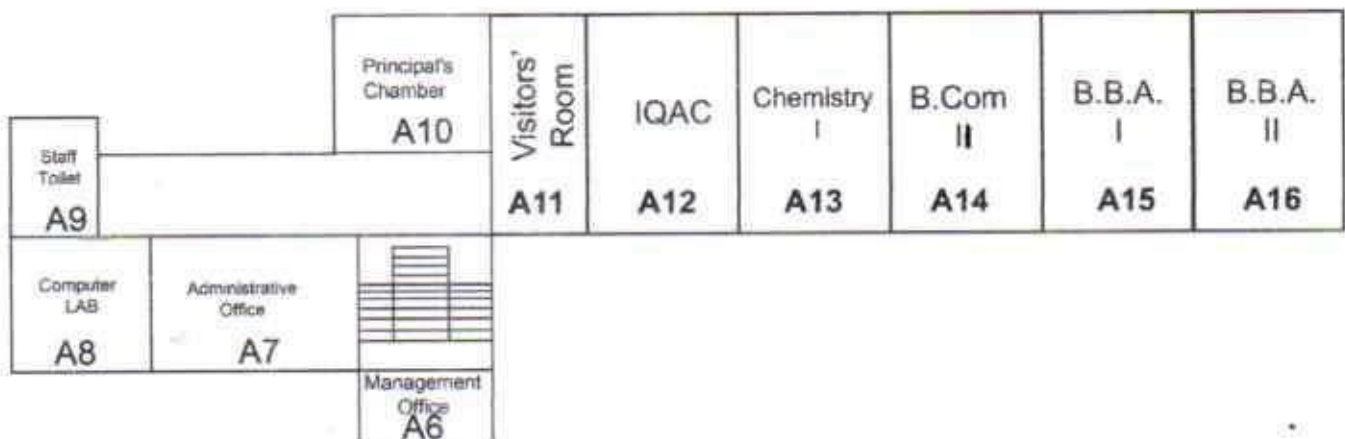
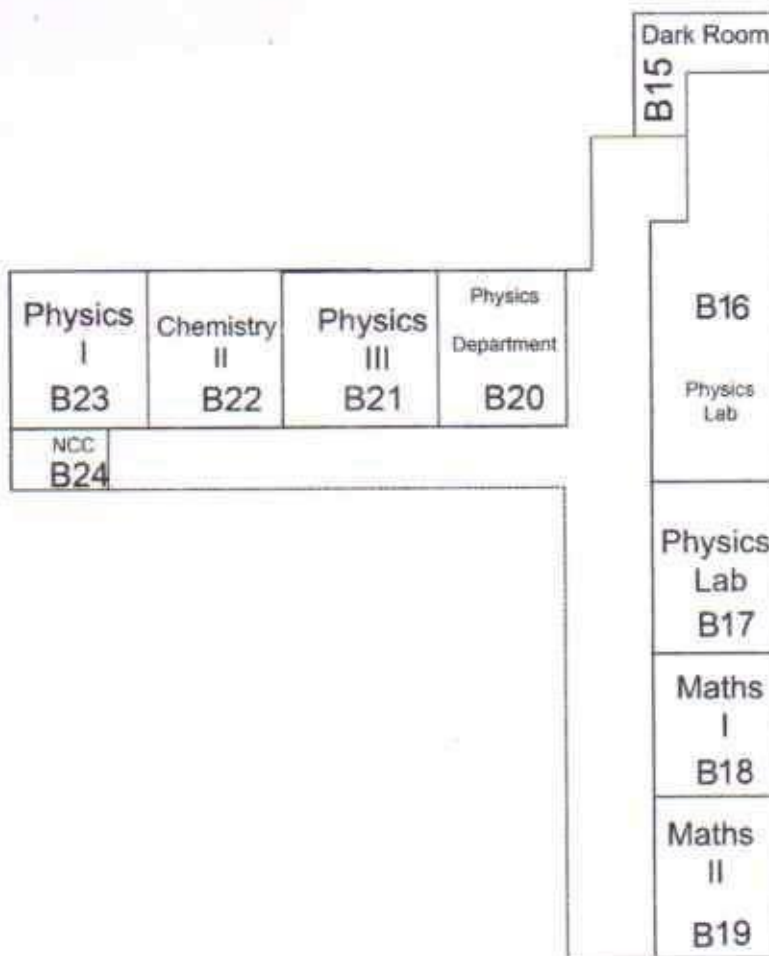

First Floor Layout



Second Floor Layout

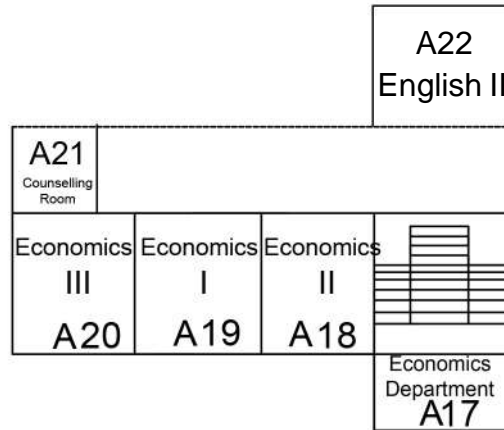

Third Floor Layout



Cellar Floor Layout

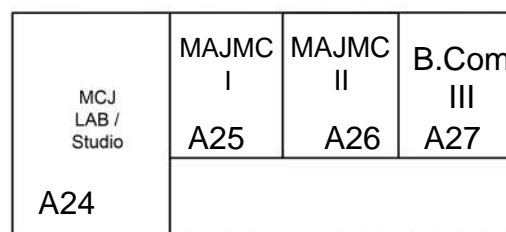

S E S COLLEGE, (Unaided) Sreekandapuram

Building Layout

Ground Floor

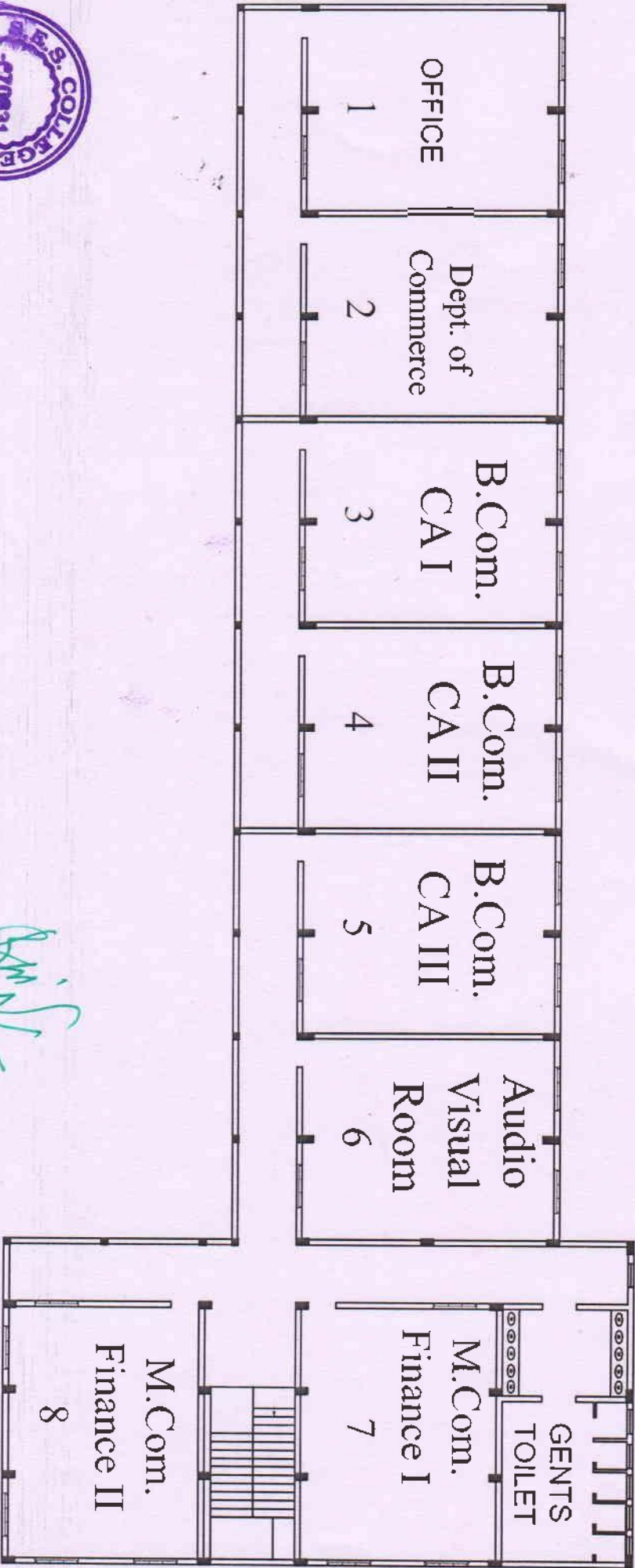

Signature

PRINCIPAL
S.E.S. COLLEGE
SREEKANDAPURAM

First Floor

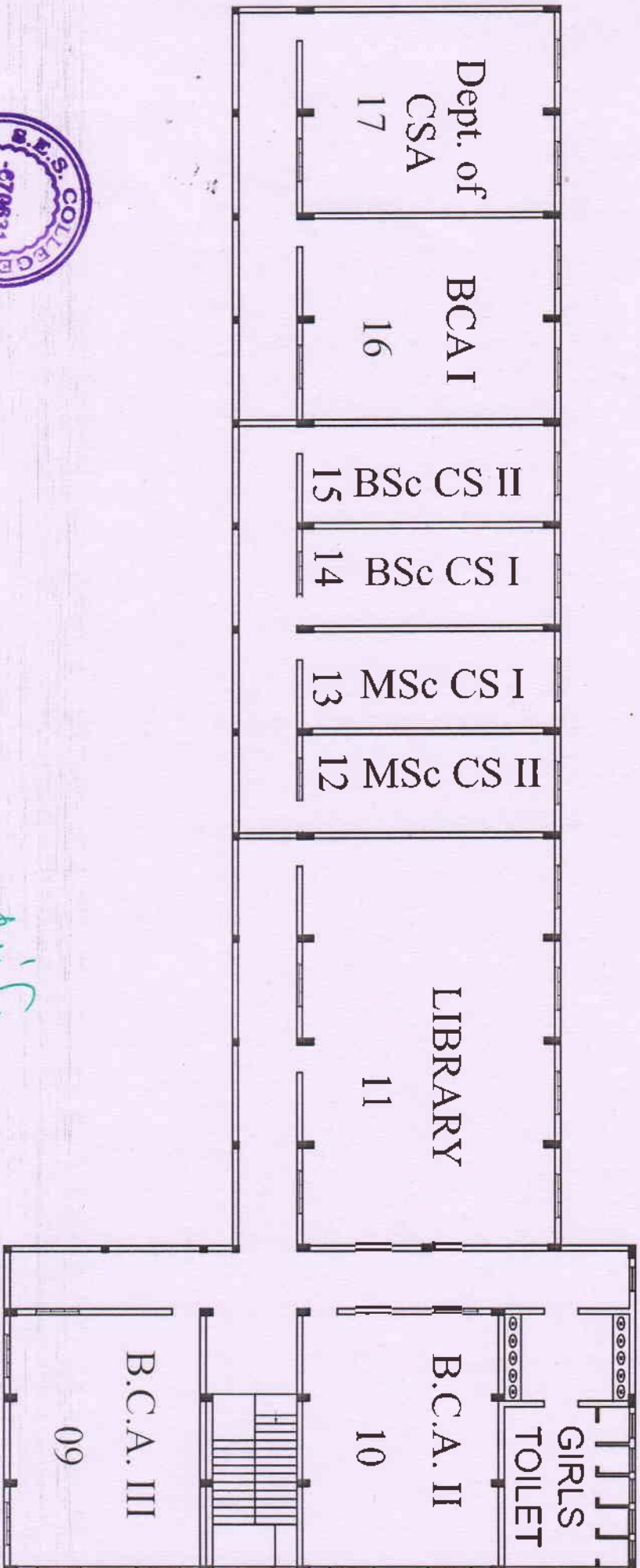

Principal
PRINCIPAL
S.E.S. COLLEGE
SREEKANANTHAPURAM

Second Floor

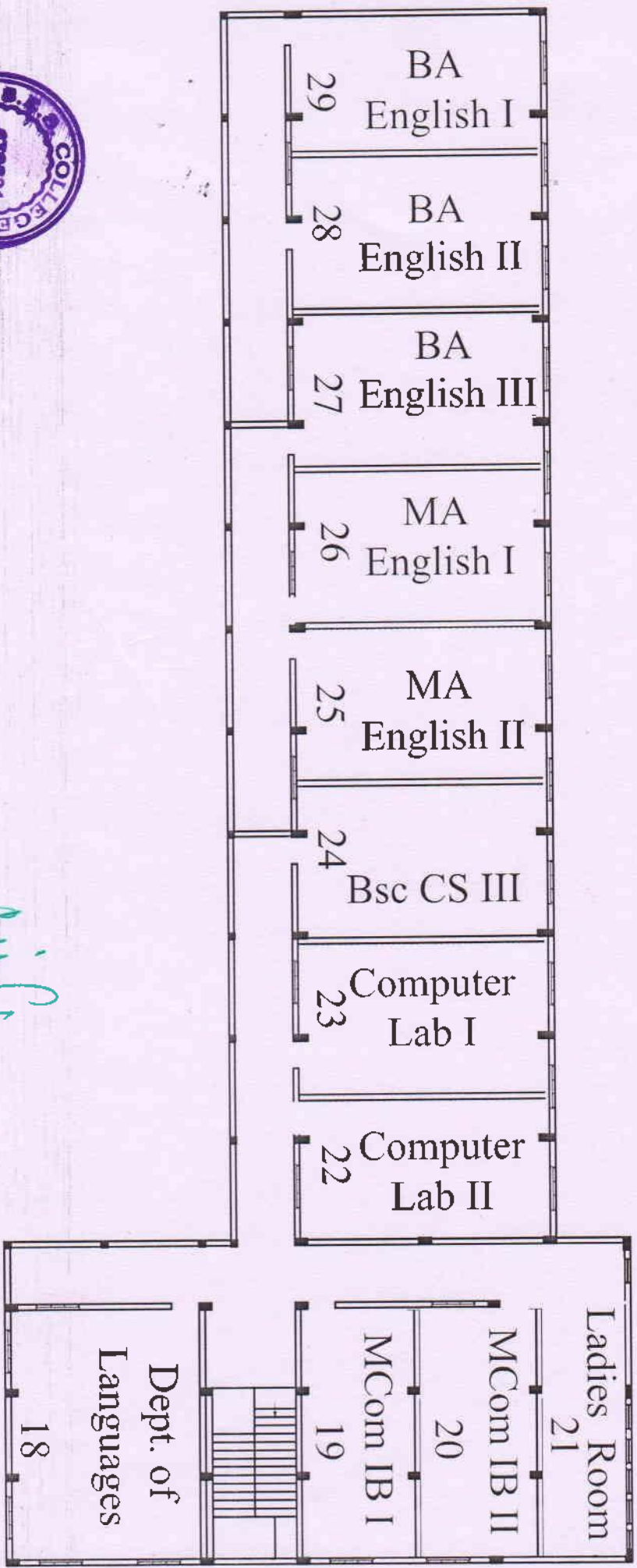

[Signature]
PRINCIPAL
S.E.S. COLLEGE
SREEKANTHAPURAM



SES COLLEGE SREEKANDAPURAM

(Accredited by NAAC with 'B' Grade) Affiliated to Kannur University



Criterion 4

Infrastructure and Learning Resources

4.1 Physical Facilities

4.1.1 The Institution has adequate infrastructure and physical facilities for teaching- learning. viz., classrooms, laboratories, computing equipment etc.



Thalakode Kerala India ● 33°C

SES College Rd, Thalakode, Kerala
670631, India

Lat: 12.03 | Long: 75.52

10/11/2022 2:22 pm, GMT+05:30

Thu 10 Nov

SES College Rd Thalakode Thalapuram
Google



1. Introduction
 2. Objectives
 3. Scope
 4. Methodology
 5. Results
 6. Discussion
 7. Conclusion

Thalakode Kerala India ● **33°C**
SES College Rd, Thalakode, Kerala
670631, India
Lat: 12.03 | Long: 75.52
10/11/2022 2:22 pm, GMT+05:30
Thu 10 Nov

 SES College
 Thalapuram
 ..
 ..



GPS Map Camera



Thalakode, Kerala, India

SES College Rd, Thalakode, Kerala 670631, India

Lat 12.026043°

Long 75.51815°

10/11/22 11:30 AM GMT +05:30

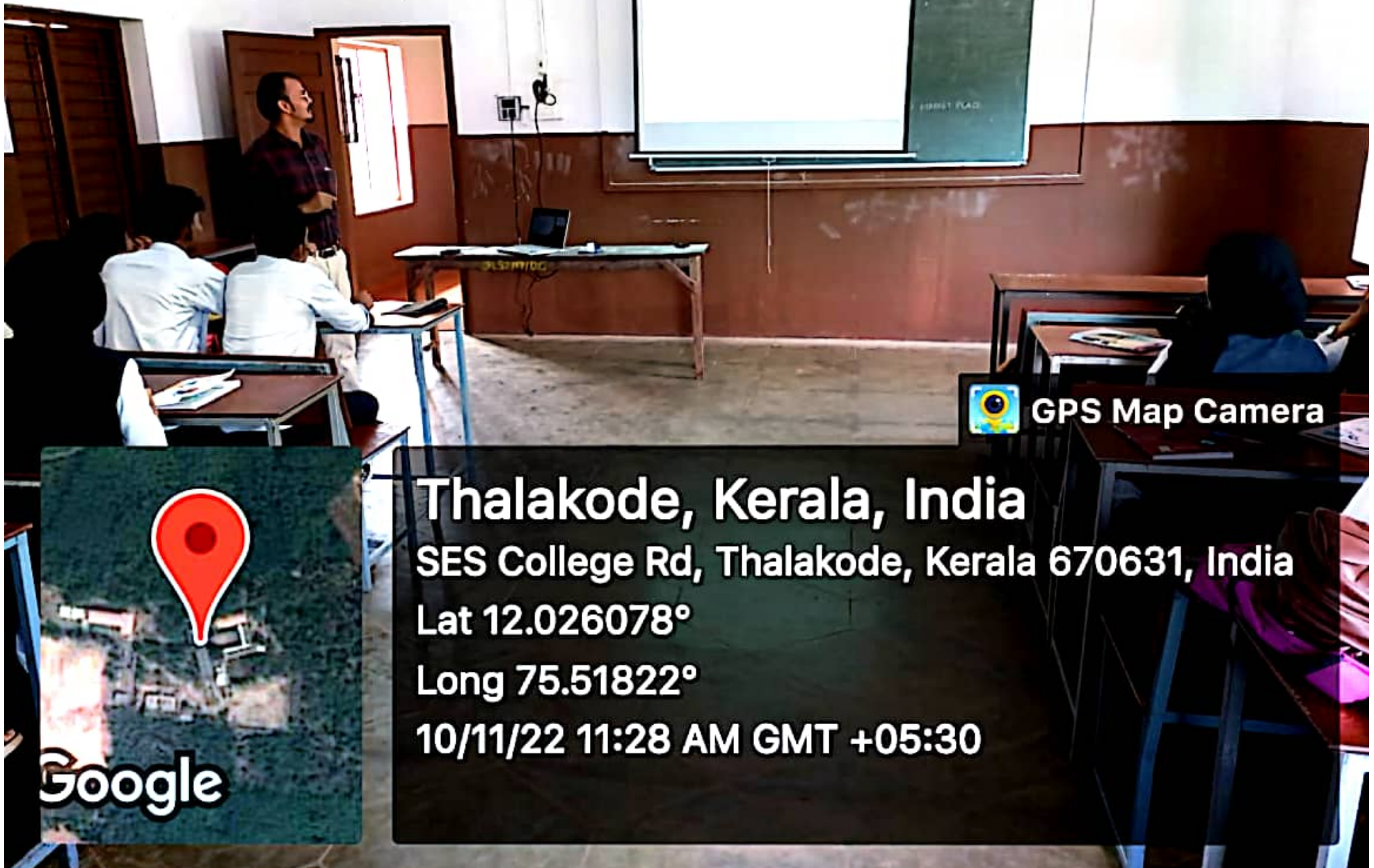

GPS Map Camera



Thalakode, Kerala, India

SES College Rd, Thalakode, Kerala 670631, India

Lat 12.026078°

Long 75.51822°

10/11/22 11:28 AM GMT +05:30



2022/10/10 10:37



 **Note cam lite**
Address : null,Thalakode,Kerala,India
Latitude : 12.025786666666667°
Longitude : 75.518166666666667°
Altitude : -6.7 meter
Date : 09/20/2022 12:15 PM
Accuracy : 4.3 meter
Time zone : GMT+05:30
Note : Captured by Note cam



GPS Map Camera

College
uram



Google

Thalakode, Kerala, India
SES College Rd, Thalakode, Kerala 670631, India
Lat 12.026113°
Long 75.518723°
20/09/22 12:25 PM



 GPS Map Camera

College
ouram



...

...



Thalakode, Kerala, India
SES College Rd, Thalakode, Kerala 670631, India
Lat 12.026001°
Long 75.518505°
17/08/22 12:10 PM



GPS Map Camera



Thalakode, Kerala, India

SES College Rd, Thalakode, Kerala 670631, India

Lat 12.02626°

Long 75.518719°

20/09/22 12:04 PM GMT +05:30

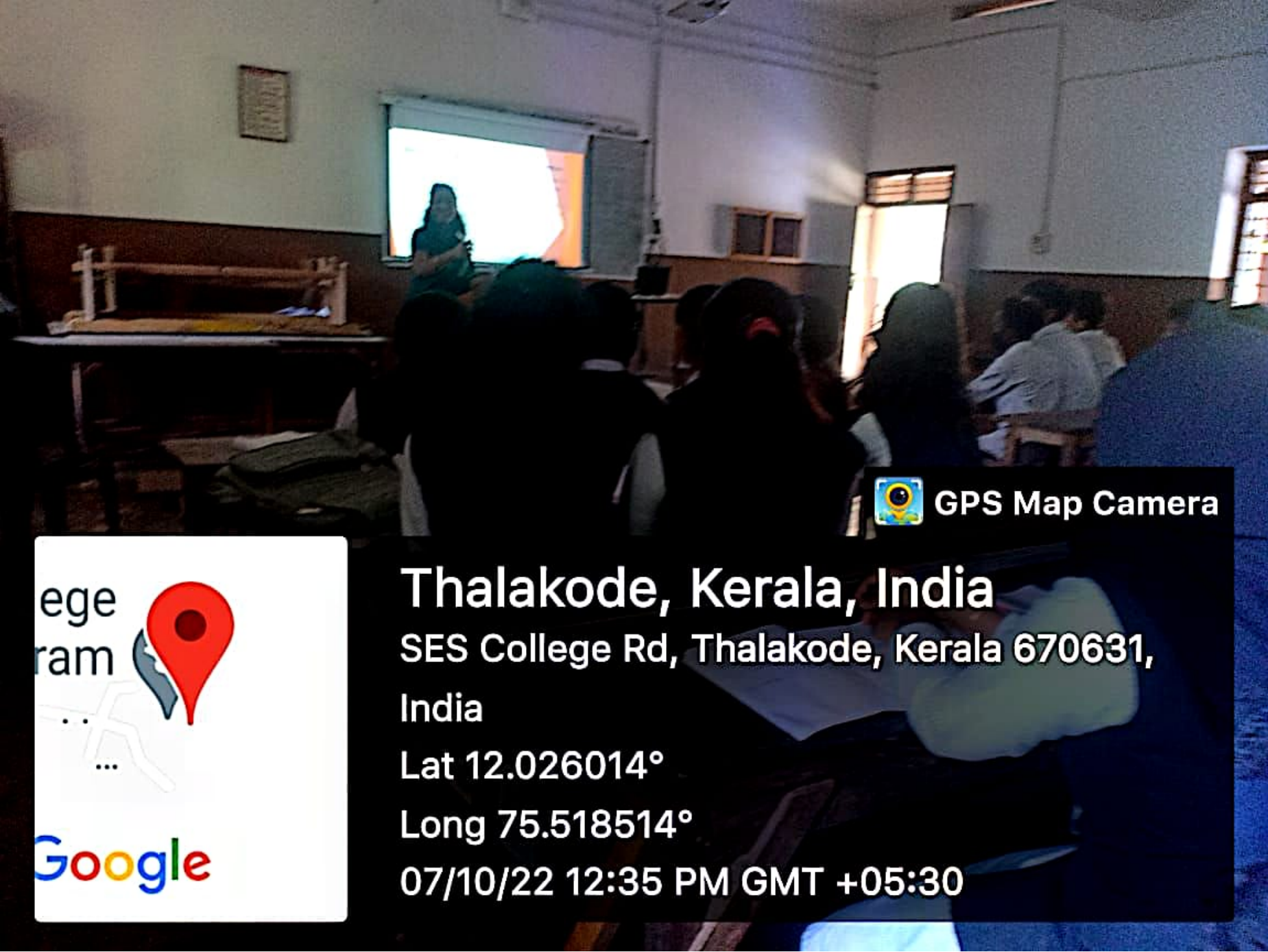

 **GPS Map Camera**

ge
ram



...

...



Thalakode, Kerala, India
SES College Rd, Thalakode, Kerala 670631,
India
Lat 12.026014°
Long 75.518514°
07/10/22 12:35 PM GMT +05:30

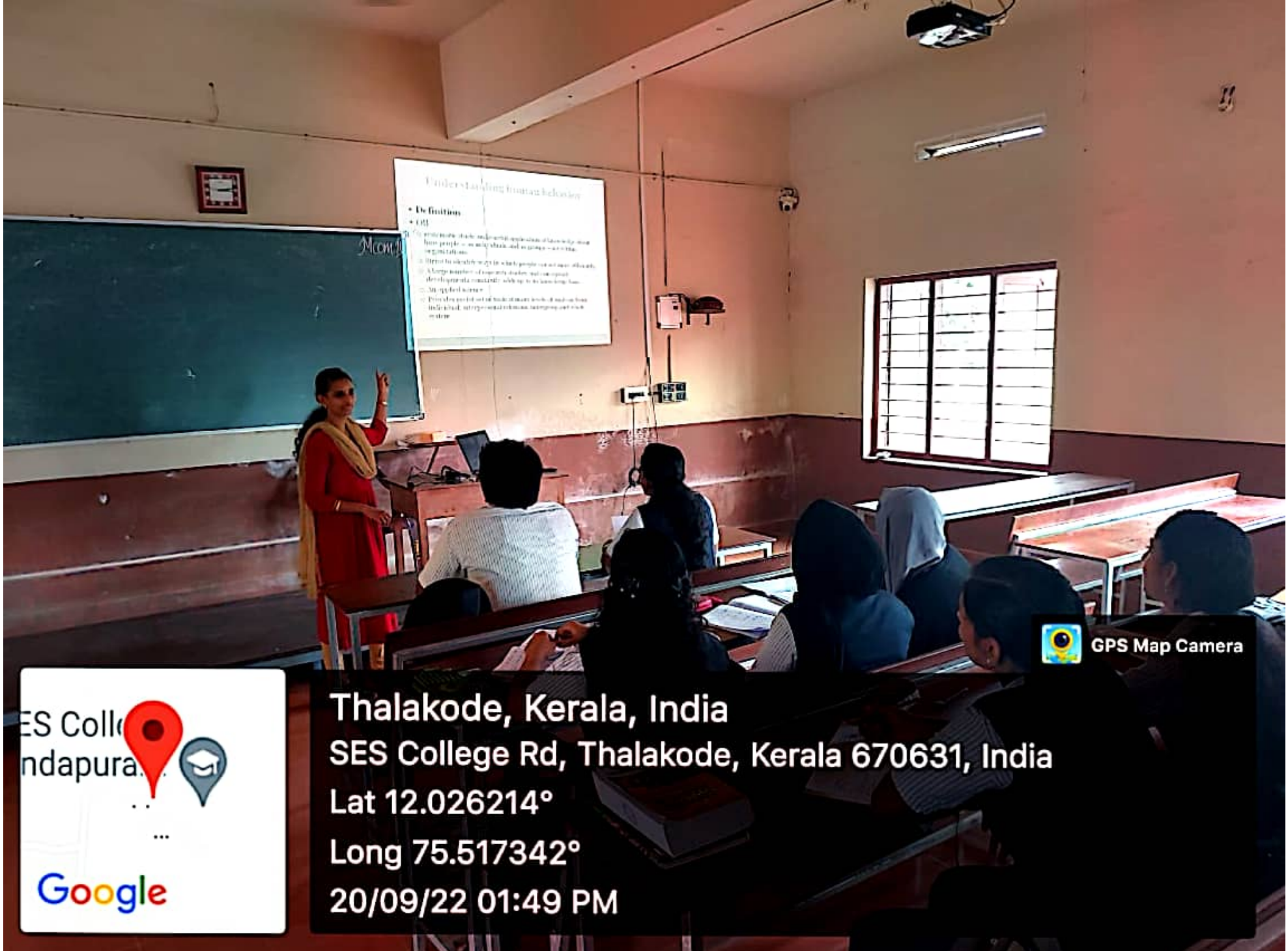

Understanding human behavior

- Definition
- It is the study of the individual and social behavior of human beings. It is the study of the individual and social behavior of human beings. It is the study of the individual and social behavior of human beings.

SES College
Thalapakura

Google

Thalakode, Kerala, India
 SES College Rd, Thalakode, Kerala 670631, India
 Lat 12.026214°
 Long 75.517342°
 20/09/22 01:49 PM

GPS Map Camera



 GPS Map Camera

SES College
Thalapakura



Google

Thalakode, Kerala, India
SES College Rd, Thalakode, Kerala 670631, India
Lat 12.026213°
Long 75.517351°
20/09/22 01:48 PM



SES College
Thalapakuram

Google

Thalakode, Kerala, India
SES College Rd, Thalakode, Kerala 670631, India
Lat 12.026481°
Long 75.517161°
19/09/22 02:18 PM

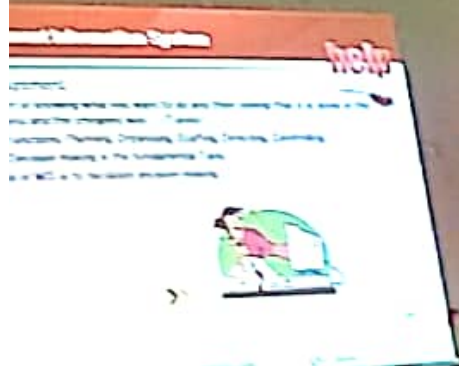

1) Planning
2) Monitoring
3) Forecasting
4) Assessment & Review

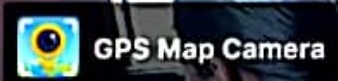

SES Coll
andapura

Google

Thalakode, Kerala, India
SES College Rd, Thalakode, Kerala 670631, India
Lat 12.026288°
Long 75.51724°
19/09/22 02:18 PM

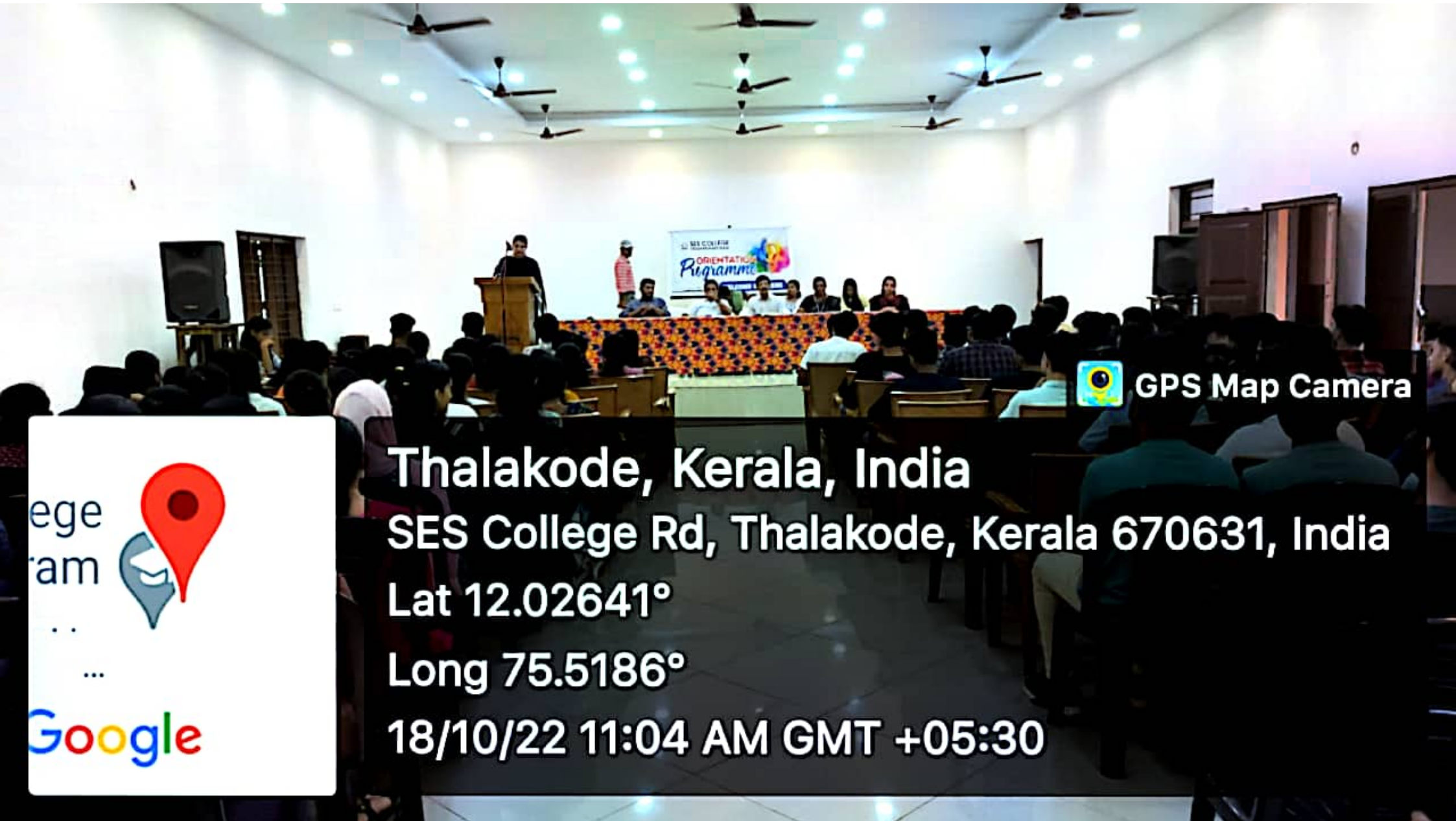

GPS Map Camera

ge
am
...
...
Google

Thalakode, Kerala, India

SES College Rd, Thalakode, Kerala 670631, India

Lat 12.02641°

Long 75.5186°

18/10/22 11:04 AM GMT +05:30